

Handwritten note: $\tan 30 = \frac{25}{55}$

Handwritten note: 67

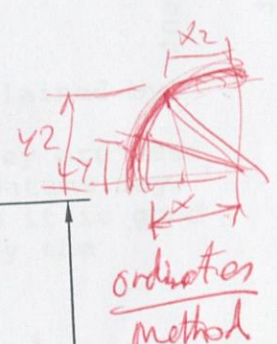

Handwritten note: ordinate method

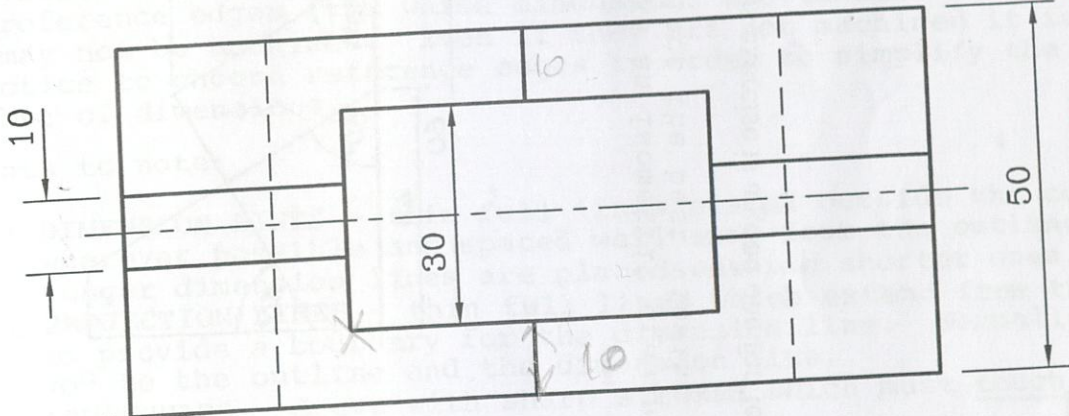

A

DRAW, FULL SIZE, AN ISOMETRIC VIEW OF THE ABOVE COMPONENT WITH CORNER "A" AS THE LOWEST CORNER

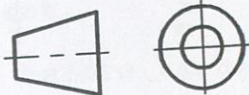
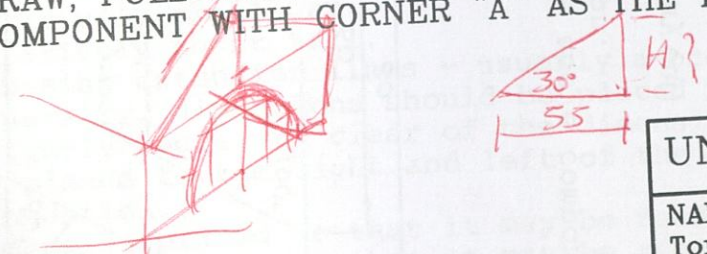

UNIVERSITY OF LIMERICK	
NAME Tony Rynne	TITLE ISOMETRIC DRAWING
DATE	
SCALE NTS	DEPT. Man. & Op. Eng.